

LP Gas Installation (Typical)

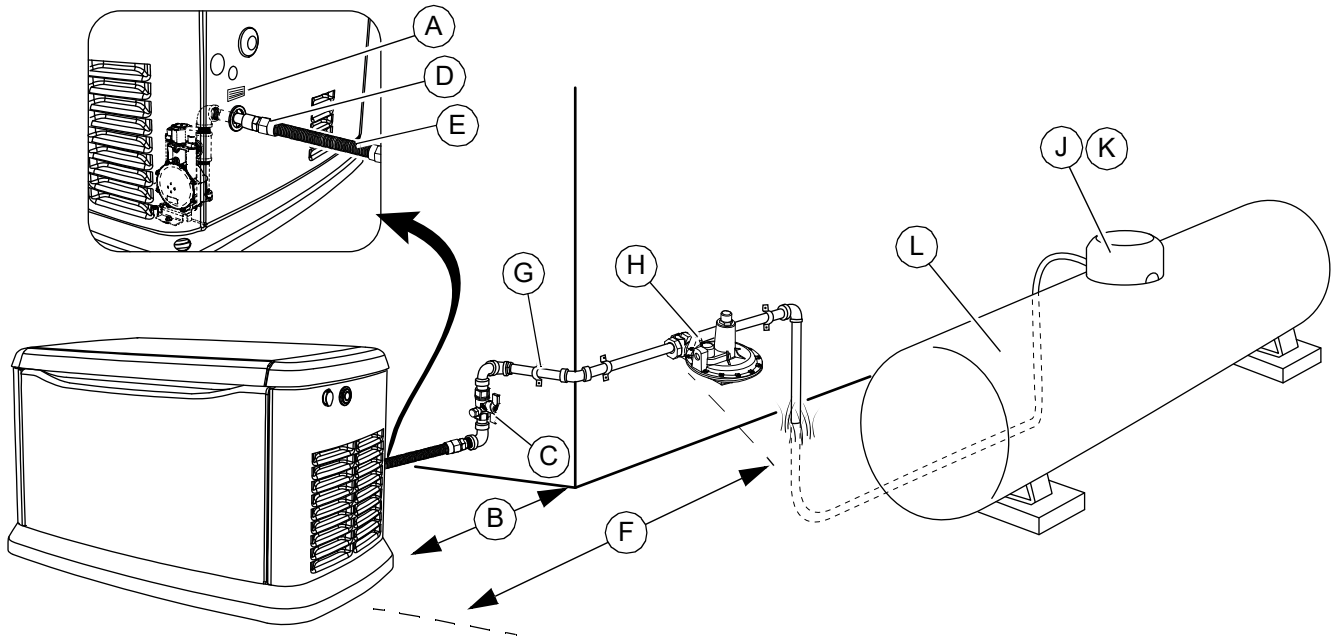

008966

LPG Megajoules/h = m ³ /h X 93.15		BTU/h = ft ³ /h X 2520
A	Fuel data decal	
B	Minimum distance from rear obstruction—see unit installation manual for distance requirements	
C	Manual fuel shutoff valve (pressure port optional) Must be located no more than 6 ft (1.83 m) away from fuel inlet.	
D	Pipe fittings (field supplied)	
E	Flexible fuel line	
F	Verify minimum distance requirements for regulator vent according to local gas codes. Regulator should be a minimum of 5 ft (1.5 m) from generator. Local codes and regulator manufacturer may have further clearance requirements.	
G	Clamp	
H	Secondary fuel pressure regulator	
J	Manual fuel shutoff valve	
K	Primary fuel pressure regulator	
L	Fuel tank—sized large enough to provide required MJ/BTU for generator set operating at FULL load and ALL connected appliance loads. Be sure to correct for weather evaporation.	
M	Sediment trap	

Figure 3-4. LP Gas Vapor Installation (typical)